

KT 10000

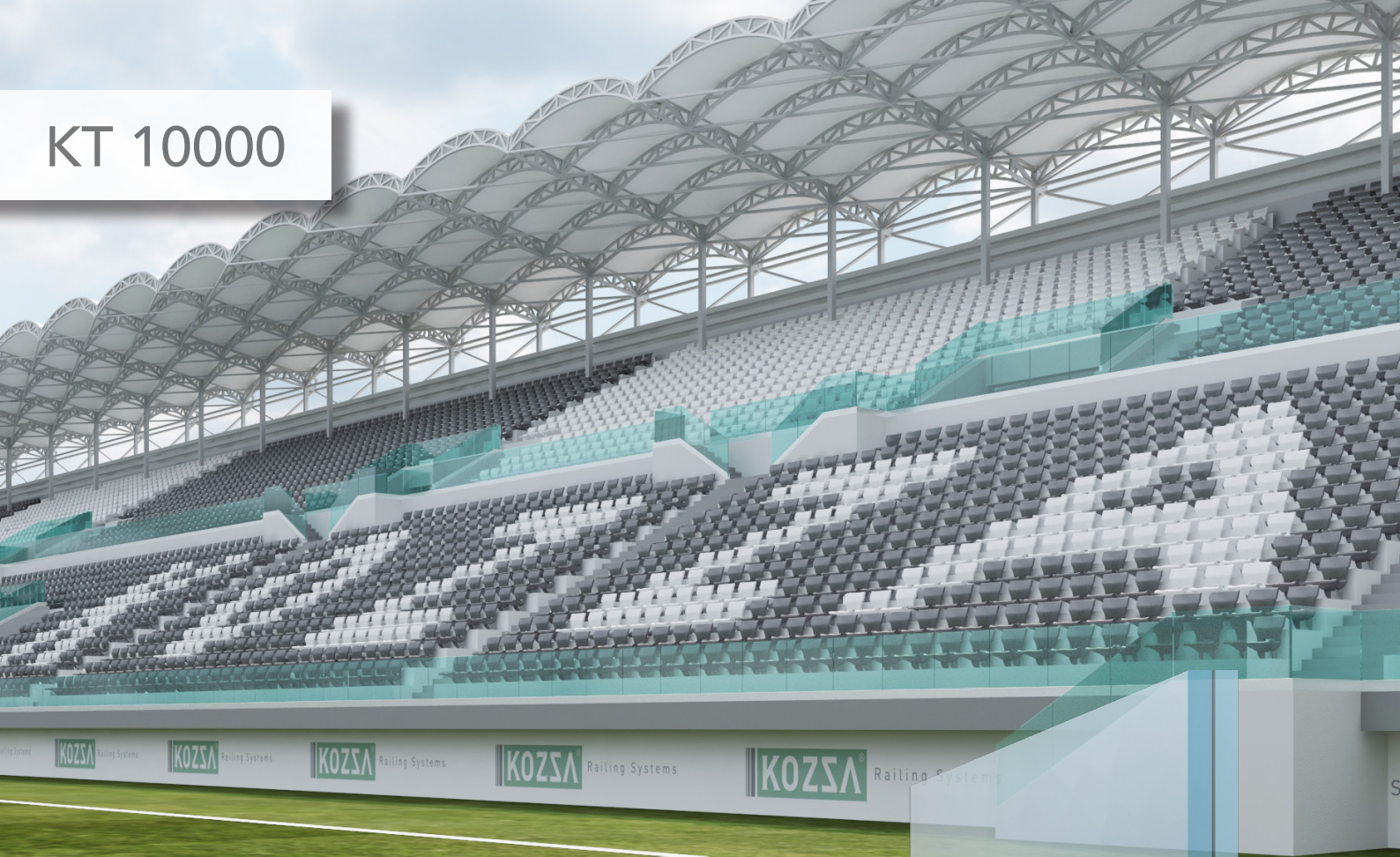

EN: The **Glassmove®** mechanism, which provides flexibility for the glass is available in the KT series. The KT 10000 series was developed and structured in line with the recommendation and demands of architectures in the application field, and it may be used in larger projects such as airports and stadiums.

Thickness of the glass may be selected optionally between 20 -31,52 millimeters.

FR: Le mécanisme **Glassmove®**, qui offre de la flexibilité pour le verre, est disponible dans la série KT. La série KT 10000 a été développée et structurée conformément aux recommandations et aux exigences des architectures dans le domaine, et peut être utilisée dans des grands projets tels que les stades et les aéroports.

L'épaisseur du verre peut être choisie en option entre 20 et 31,52 millimètres.

DE: Der **Glassmove®**-Mechanismus, der Flexibilität für das Glas bietet, ist in der KT-Serie erhältlich. Die KT 10000-Serie wurde gemäß den Empfehlungen und Anforderungen von Architekturen im Anwendungsbereich entwickelt und strukturiert und kann in größeren Projekten wie Stad'en und Flughafen.

Die Dicke des Glases kann optional zwischen 20 und 31,52 Millimetern gewählt werden.

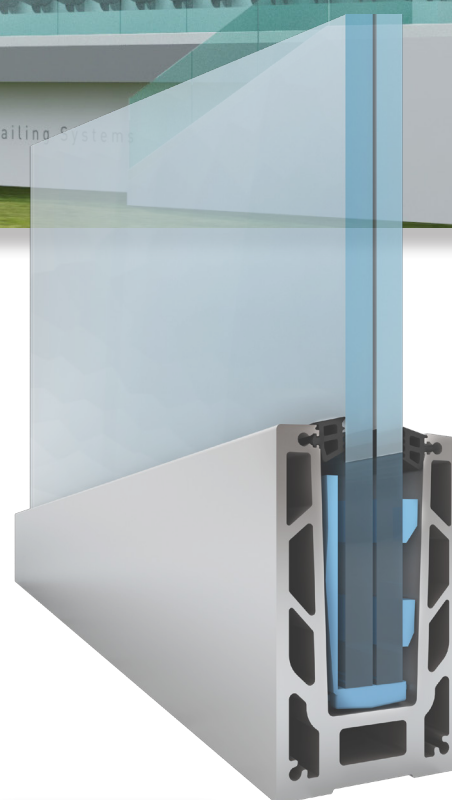

KT 10000 CODES

- KT10000.250.00
- KT10000.500.00

PROFILE DRAWING

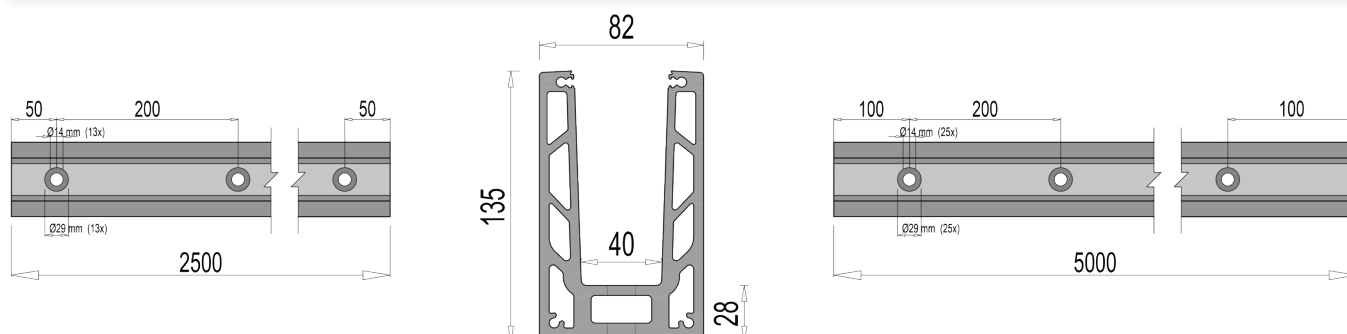

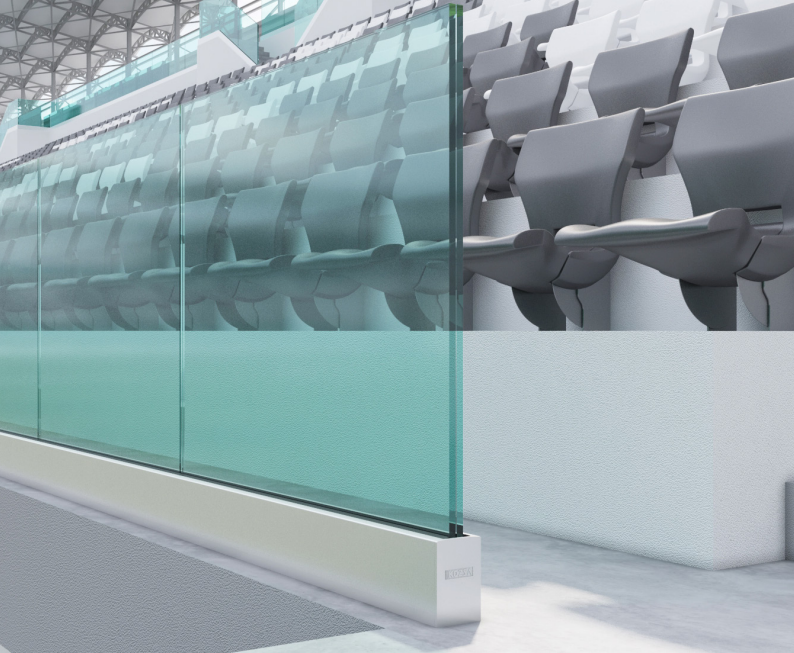

LOAD CAPACITY

- EN:** Aluminum alloy EN AW 6063 displacement results for 1 mt base profile under 300 kg (3000 nt) horizontal load to the highest surface of the profile.
- FR:** Alliage d'aluminium EN AW 6063 résultats de déplacement pour un profil de base de 1 mt sous une charge horizontale de 300 kg (3000 nt) sur la surface la plus élevée du profil.
- DE:** Die Verschiebung der Aluminiumlegierung EN AW 6063 ergibt ein Grundprofil von 1 m bei einer horizontalen Belastung von 300 kg (3000 nt) auf die höchste Oberfläche des Profils.



Glassmove® INFO

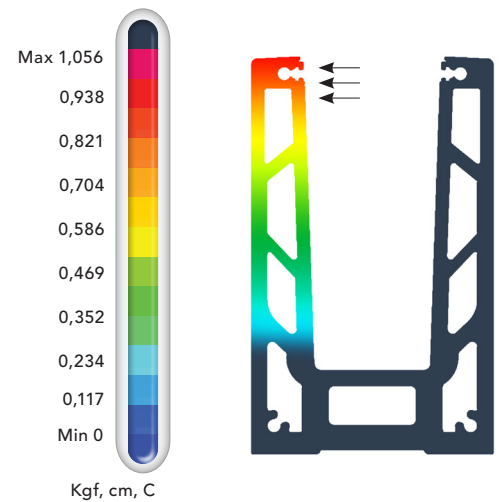
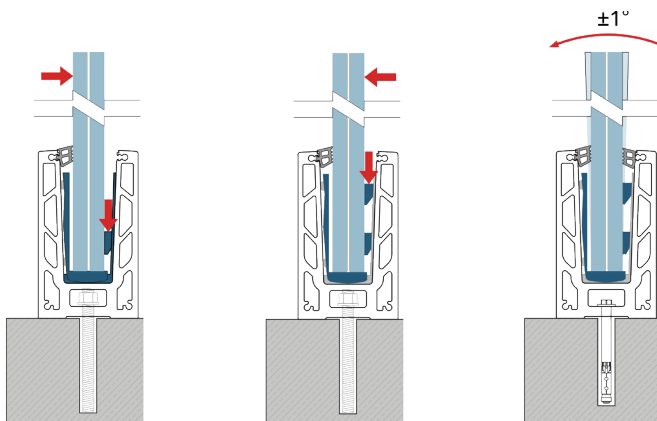

Displacement Values

ANCHORING POSSIBILITY FOR THE KT - 10000

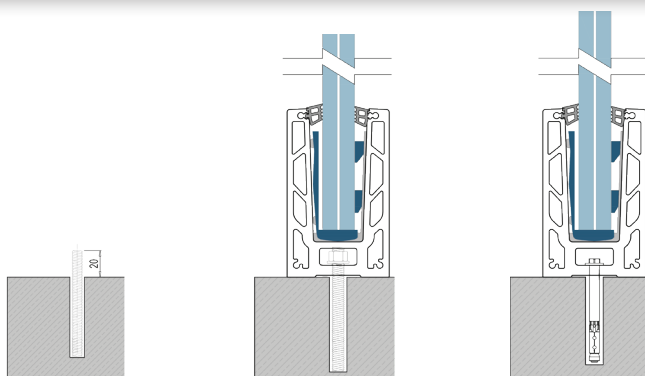

DRAINAGE DETAILS

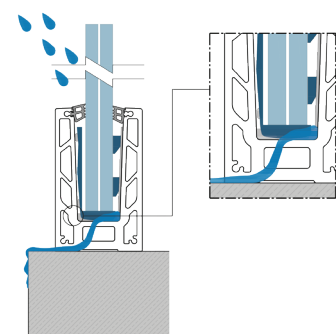

INSTALLATION PART I

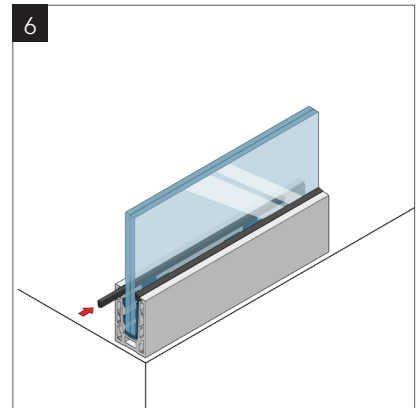
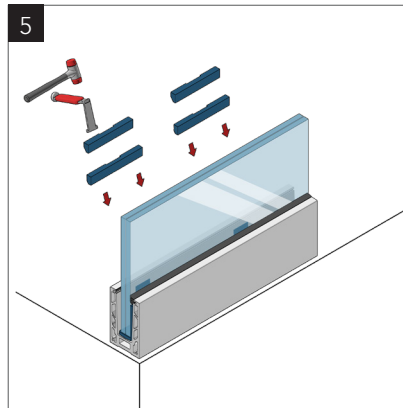
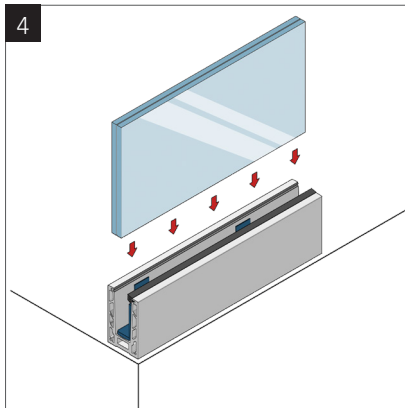
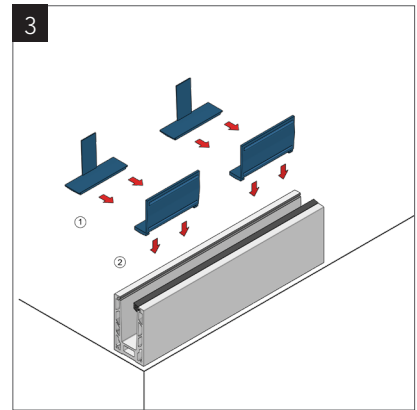
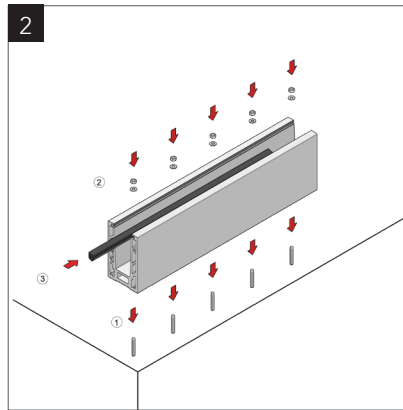
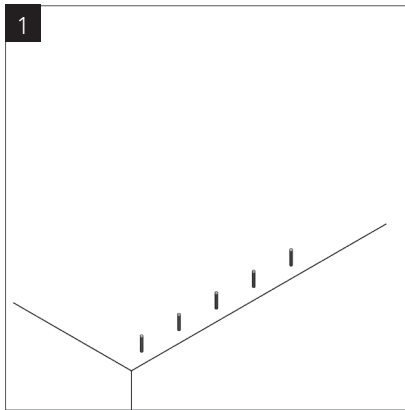

INSTALLATION PART II

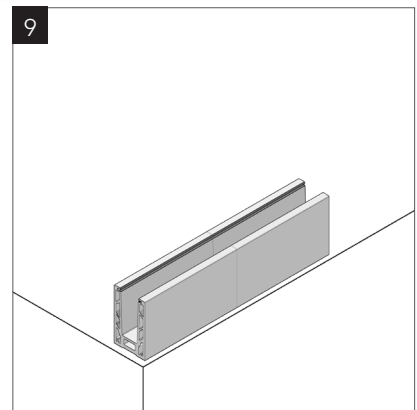
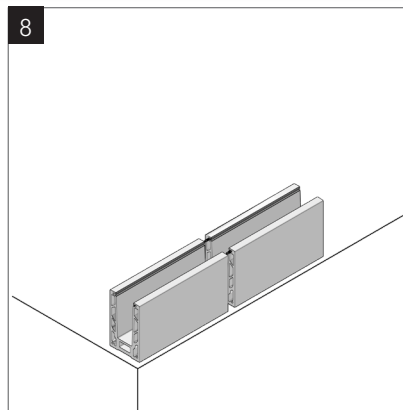
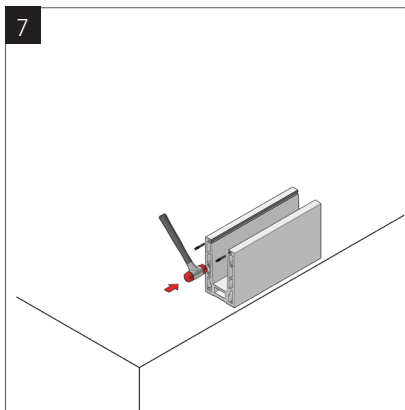

INSTALLATION PART III

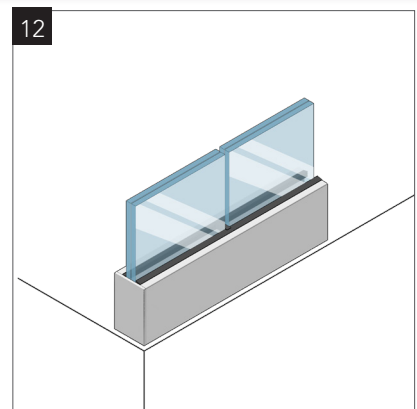
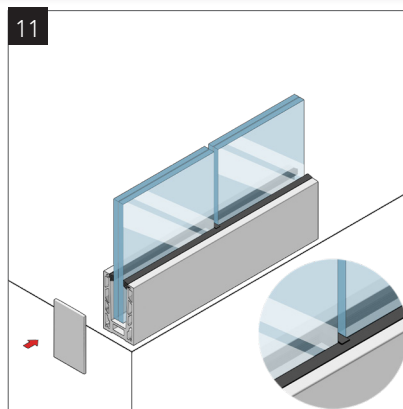
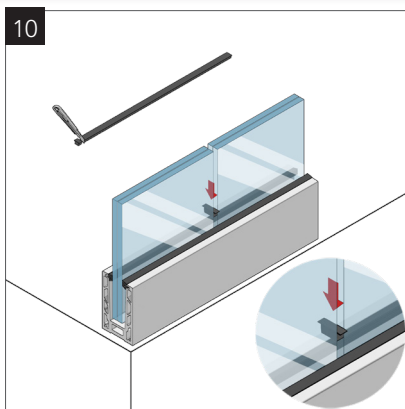

KT 10000 - Glass Railing Systems



GLASS PROFILE KT 10000

KT 10000	MILL FINISH	MAT ANODISE	BRIGHT ANODISE	STAINLESS STEEL EFFECT	RAL COLOURED
Length	Code	Code	Code	Code	Code
2500 MM	10000.250.10	10000.250.20	10000.250.30	10000.250.40	10000.250.50
5000 MM	10000.500.10	10000.500.20	10000.500.30	10000.500.40	10000.500.50

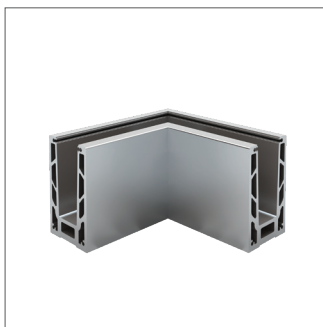

CORNER 90°

KT 10000	MILL FINISH	MAT ANODISE	BRIGHT ANODISE	STAINLESS STEEL EFFECT	RAL COLOURED
INSIDE/OUTSIDE	Code	Code	Code	Code	Code
	10000.100.10	10000.100.20	10000.100.30	10000.100.40	10000.100.50



END CAP

KT 10000	MILL FINISH	MAT ANODISE	BRIGHT ANODISE	STAINLESS STEEL EFFECT	RAL COLOURED
LEFT / RIGHT	Code	Code	Code	Code	Code
	10000.120.10	10000.120.20	10000.120.30	10000.120.40	10000.120.50

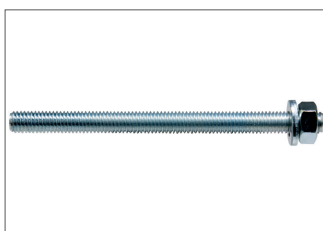

FIXING ANCHOR M12x150

Code
9820.010.00



FIXING ANCHOR M12x110

Code
9820.015.00

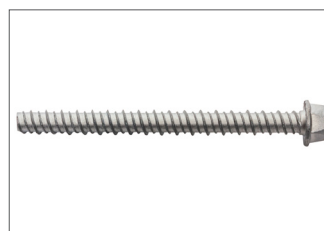

FIXING ANCHOR M12x150

Code
9820.150.00



EXTENSION PIN M5x50

Code
9850.005.00



Glassmove®

Glass Thickness	Colour	5000 MM	PCS
		Code	Code
20 - 21.52 mm	ORANGE	KT.GM 5000.020.00	KT.GM 0001.020.02
24 - 25.52 mm	GREY	KT.GM 5000.024.00	KT.GM 0001.024.02
30 - 31.52 mm	Black	KT.GM 5000.030.00	KT.GM 0001.030.02